

urbanpods™

OUR COLLECTION

Our architecturally designed pods comply fully with building regulations. This means that planning consent is not normally required and you can have your pod built at a time that suits you. With an external height of just 2.5 meters you can position your pod closer to the boundary.

THE UFFICIO

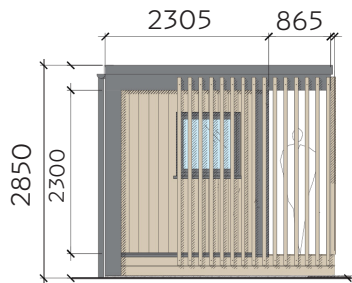

EXTERNAL
FOOTPRINT

9.41m²

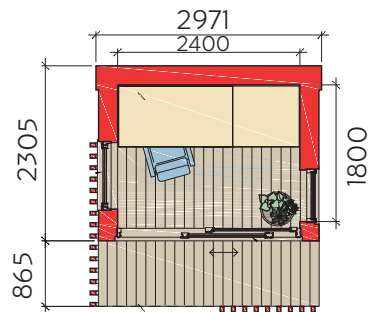

FROM £13,990 + VAT

THE MEDIO

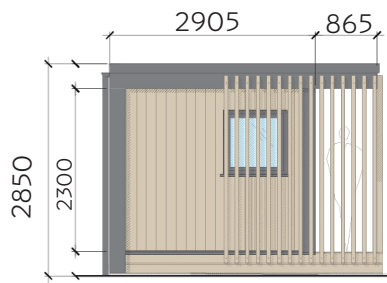

EXTERNAL
FOOTPRINT

15.72m²

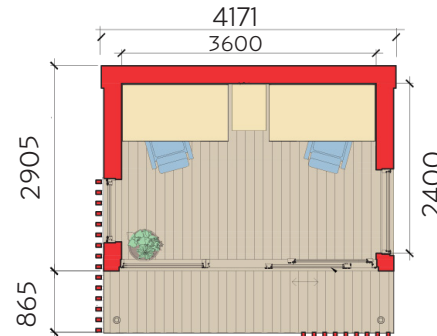

FROM £19,170 + VAT

THE MASSIMO

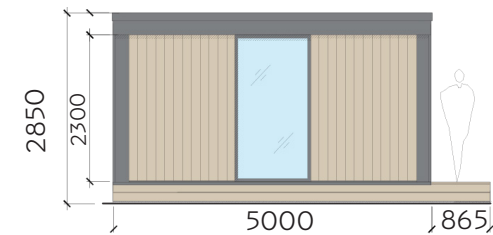

EXTERNAL
FOOTPRINT

20.55m²

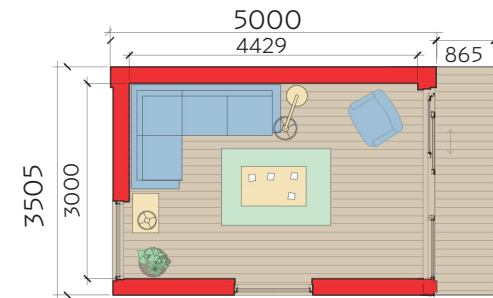

FROM £23,070 + VAT

THE PERFETTO

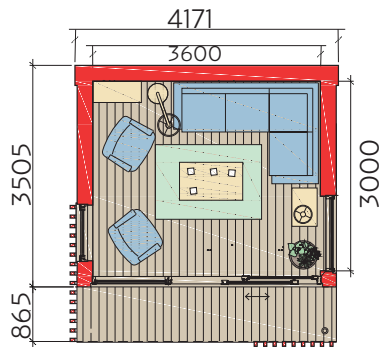
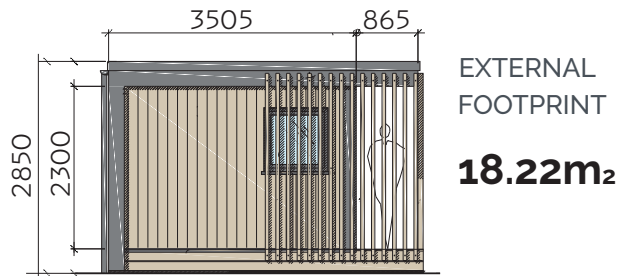

FROM £22,870 + VAT

THE PERFETTO +

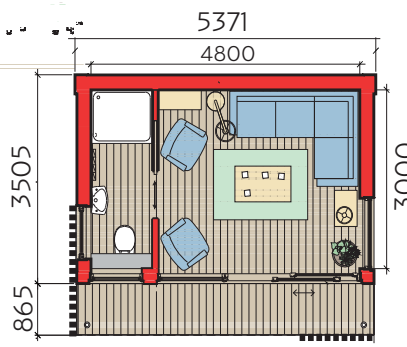
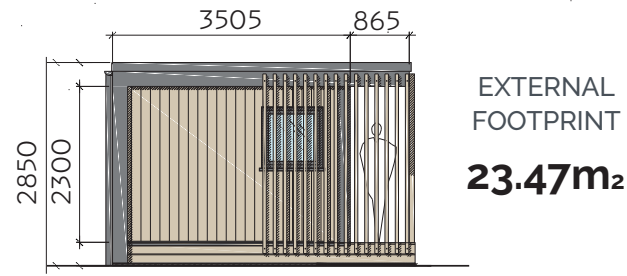

FROM £29,150 + VAT

not suitable for single units in domestic property

THE SAUNA

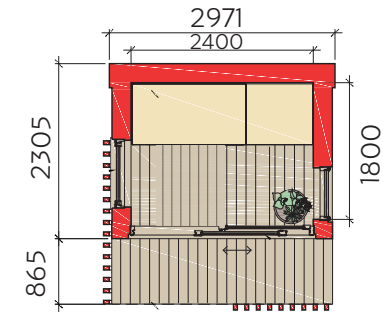
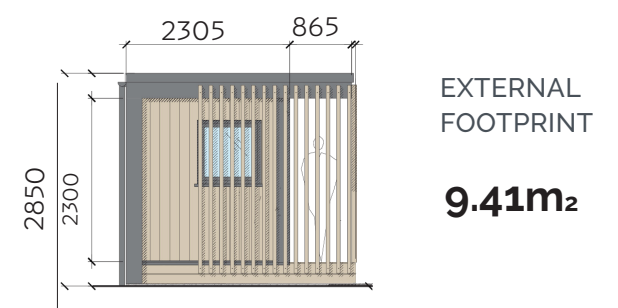

FROM £17,500 + VAT

BESPOKE PODS

If you can't find your perfect pod within our current range and you are looking for a bespoke option, we can design and make one especially for you.

Whatever your requirement, we can design and build a pod to suit your needs and because they are modular we can do this cost effectively at a price you'll like.